

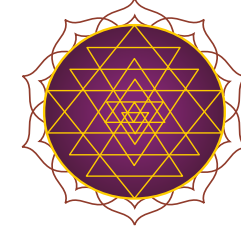

ADHISTHANA  
LUXURIA



DESIGN  
FOR  
BETTER  
LIVING



॥ अस्माकं कार्याणि  
अस्मान्वावधीकरिष्यन्ति ॥



**3 BHK EXCLUSIVE APARTMENTS**  
very close vicinity of **jain derasar** at naranpura





# Amenities



2 GOOD QUALITY LIFT



C.C. T.V. SURVEILLANCE



GAZEBO ON TERRACE



DECORATIVE FOYER



MULTI PURPOSE HALL



INTERNAL PAVED AREA



SUFFICIENT PARKING



FIRE SAFETY



SOLAR ON ROOF TOP



24 X 7 SECURITY

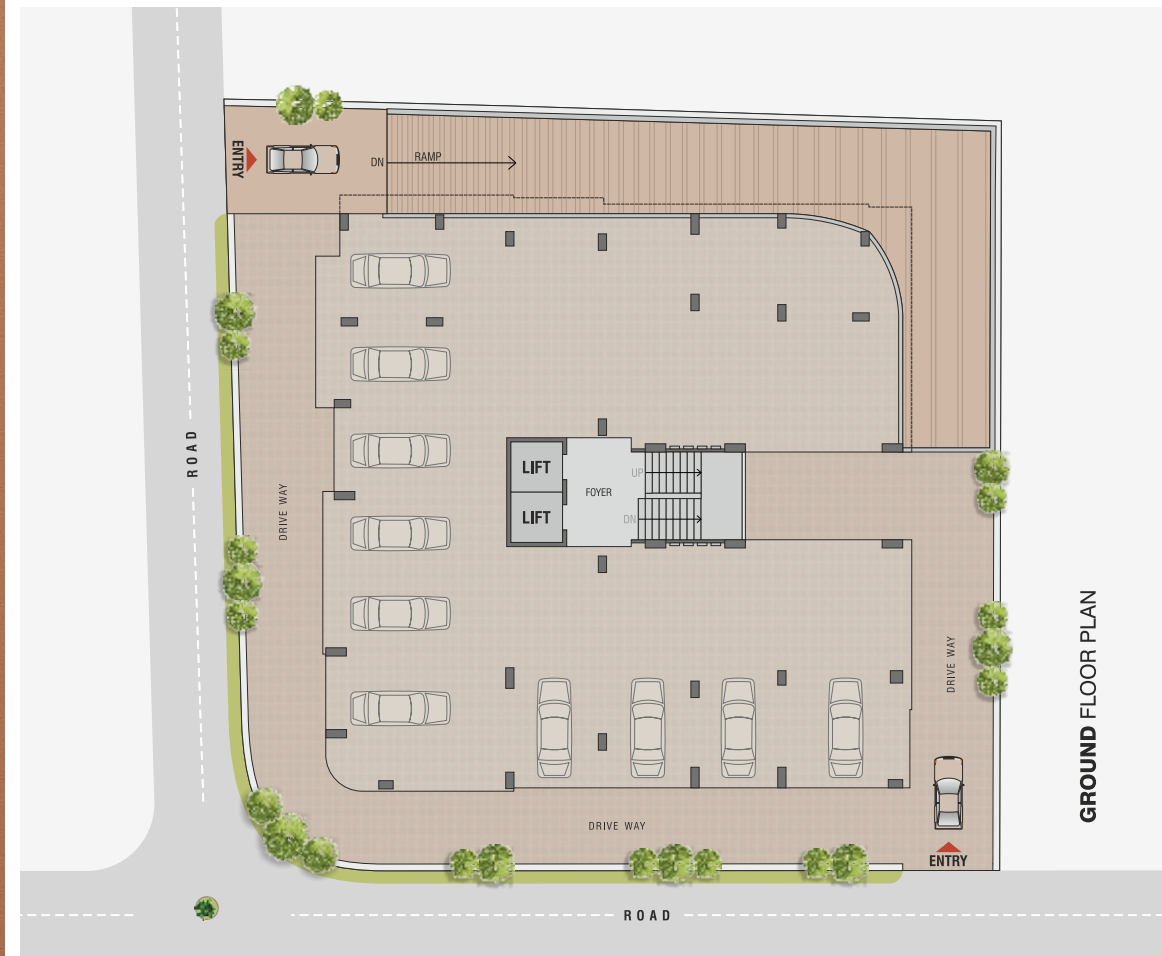
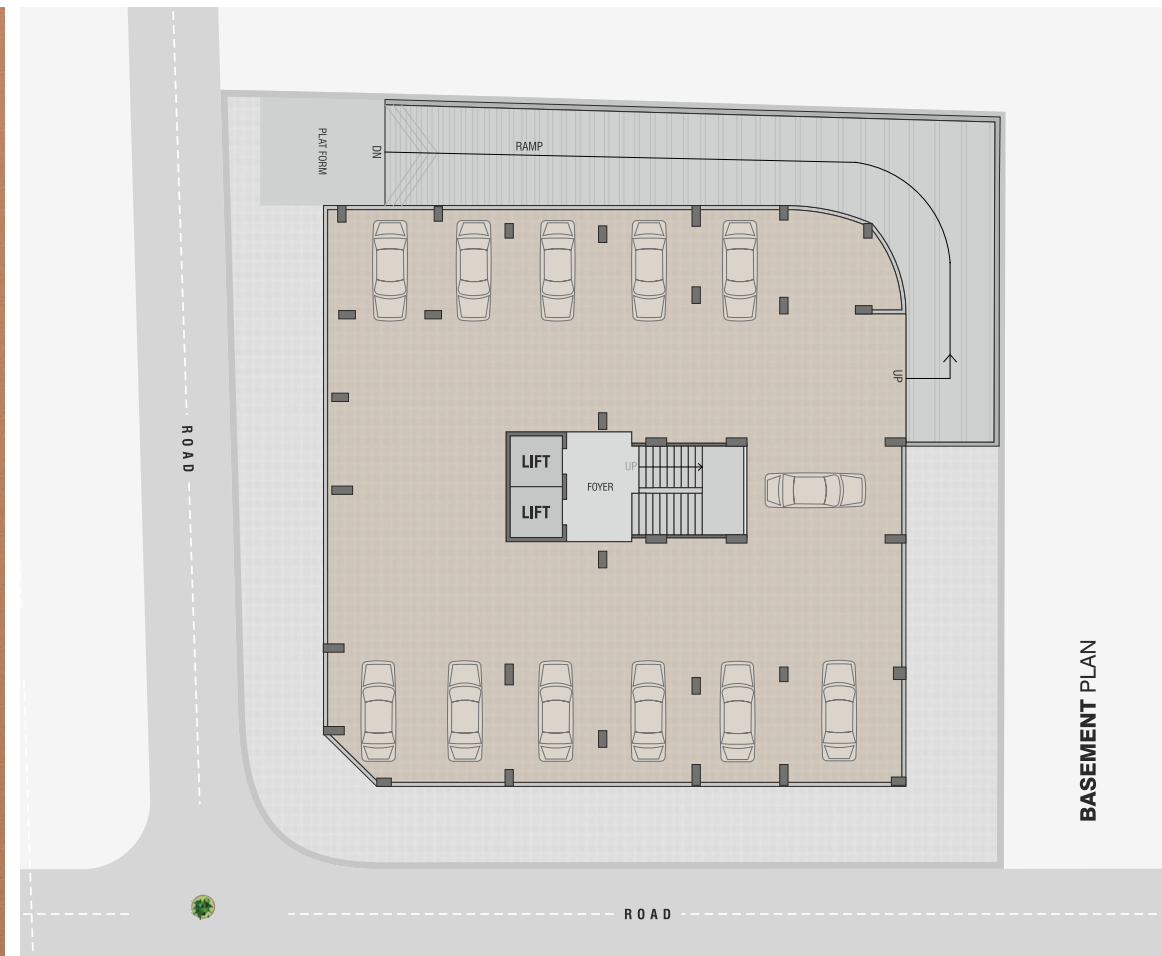

UNIT - 101, 104

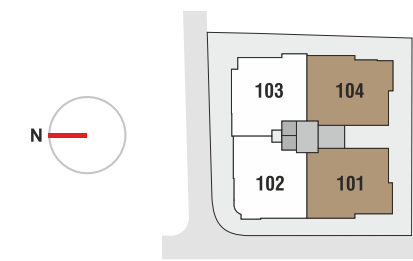



UNIT - 102

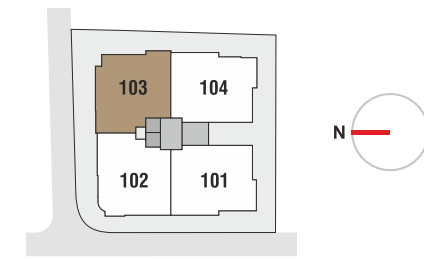
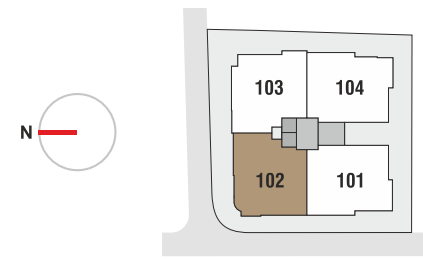

UNIT - 103



## SPECIFICATIONS



**Structure**  
Earthquake resistant R.C.C. frame structure.



**Flooring**  
Good quality Vitrified tiles in entire Apartment.



**Wall Finish**  
Internal single coat mala plaster with Putty finish. External double coat sand face plaster with good quality acrylic paint.

**Kitchen**  
Granite top platform with S.S. Sink. Glazed tiles dado up to lintel level.



**Doors & Windows**  
Decorative main door. All other doors are flush door & good quality fittings. Anodized powder coated aluminum sliding window.



**Electrification**  
Concealed copper wiring with Modular Switches & sufficient number of points with MCB distribution panel.

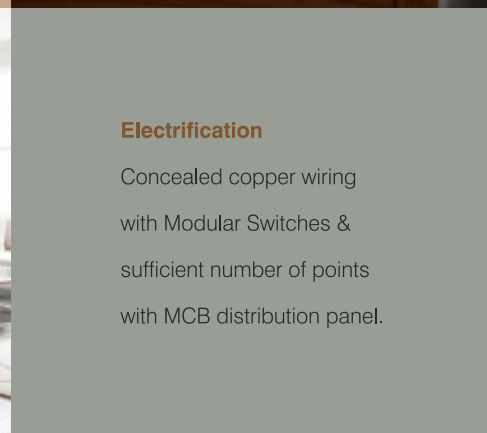

**Bathroom**  
Designer glazed tiles up to lintel level. Premium quality bath fittings & sanitary wares.



**NOTES**

- Our rates are based on as per RERA area.
- All rights reserved to organizer for any changes in plan & specification.
- Stamp duty, Registration fee, GST, miscellaneous etc. for conveyance / sale deed charges will be extra.
- All fresh levies / taxes or increase in any of the existing levies / taxes, other charges and expenses levied by state, central government or local authorities charges, Narmada water & Gujarat Gas Connection Charges will be extra.
- Any member who so ever is unable to pay the regular installment is liable to lose the membership and no explanations will be entertained thereafter.
- At the time of cancellation of booking 10% service charge of the total amount paid shall be levied & balance payment made only after the next available booking.
- Change in external elevation shall not be permitted. Internal changes shall be done only with prior permission & shall be charged extra in advance & no deduction (credit) of specified materials in extra work.
- Variation in shades & sizes likely in vitrified & glazed tiles due to constraints of availability & manufacturing.
- Details & dimensions in model & brochure are indicative and for the tentative representation only which should not be treated as legal documents or consumer contract.
- Possession of the flat shall be offered only after 15 days from the full payment.
- All possible loan papers shall be made available for procuring loans.



DEVELOPER



**ANON INFRAMANAGEMENT LLP**

MO : 98240 87090

✉ [adhishthanluxuria@gmail.com](mailto:adhishthanluxuria@gmail.com)

🌐 [www.anonprojects.com](http://www.anonprojects.com)

ARCHITECT

**UNN DESIGN SERVICES**

AR. NIMISH PANCHAL

MO : 98250 62338

STRUCTURAL ENGINEER

**SAMYAK CONSULTANTS**

MO : 99045 15186

SITE ADDRESS

**ADHISTHANA LUXURIA**

(SHUBHIPARK CO. OP. HOUSING SOCIETY LIMITED)

NEAR STHANAKWASI JAIN UPASHRAY, OPP. ZAVERI PARK,

NARANPURA, AHMEDABAD – 380013.

RERA NO : PR / GJ / AHMEDABAD / AHMEDABAD CITY / AUDA / RAA10691 / 270922

Website : [www.gujrera.gujarat.gov.in](http://www.gujrera.gujarat.gov.in)



